

KMT 7

Dimensions

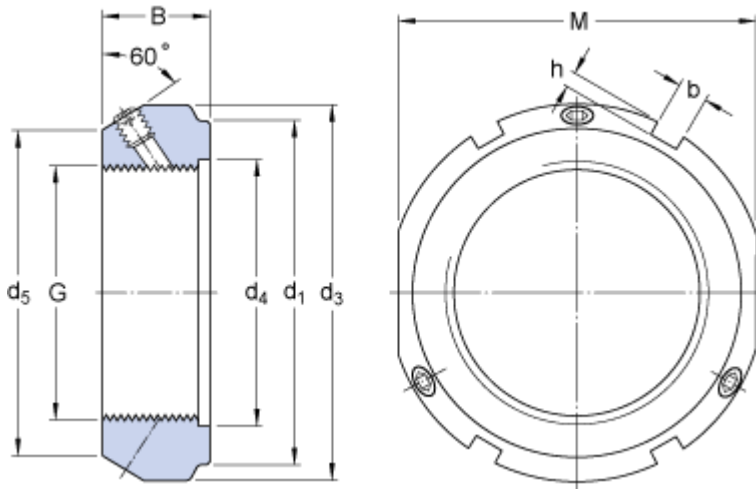

G	M 35x1.5	
d ₁	49	mm
B	22	mm
d ₃	54	mm
d ₄	38	mm
d ₅	46	mm
M	50	mm
b	5	mm
h	2	mm

Calculation data

Axial static load carrying capacity	0.19	kN
-------------------------------------	------	----

Mass

Mass	0.19	kg
------	------	----

Mounting information

Appropriate spanner	HN 7	
Grub (set) screw size	M 6	
Recommended grub screw tightening torque	8	N·m